

PROPOSED DISCHARGE RATE WITH 20% CLIMATE CHANGE ALLOWANCE (l/s):

NETWORK	RETURN PERIOD (years)			
	2	5	30	100
D	110.0	122.0	194.0	196.0
E	187.0	214.0	281.0	281.0

AT DP3 STAGE OF SCHEME, CHESHIRE COUNTY COUNCIL CONFIRMED EXISTING PUMPING STATION 4 (SEE SHEET 10) COULD ACCOMMODATE AN ADDITIONAL 700m OF NEW HIGHWAY RUNOFF. THIS IS TO BE CONFIRMED WITH CHESHIRE COUNTY COUNCIL PRIOR TO DETAIL DESIGN BEING CARRIED OUT.

PROPOSED DISCHARGE RATE WITH 20% CLIMATE CHANGE ALLOWANCE FOR 700m ADDITIONAL HIGHWAY ONLY (l/s):

RETURN PERIOD (years)	RETURN PERIOD (years)			
	2	5	30	100
289	360	468	524	

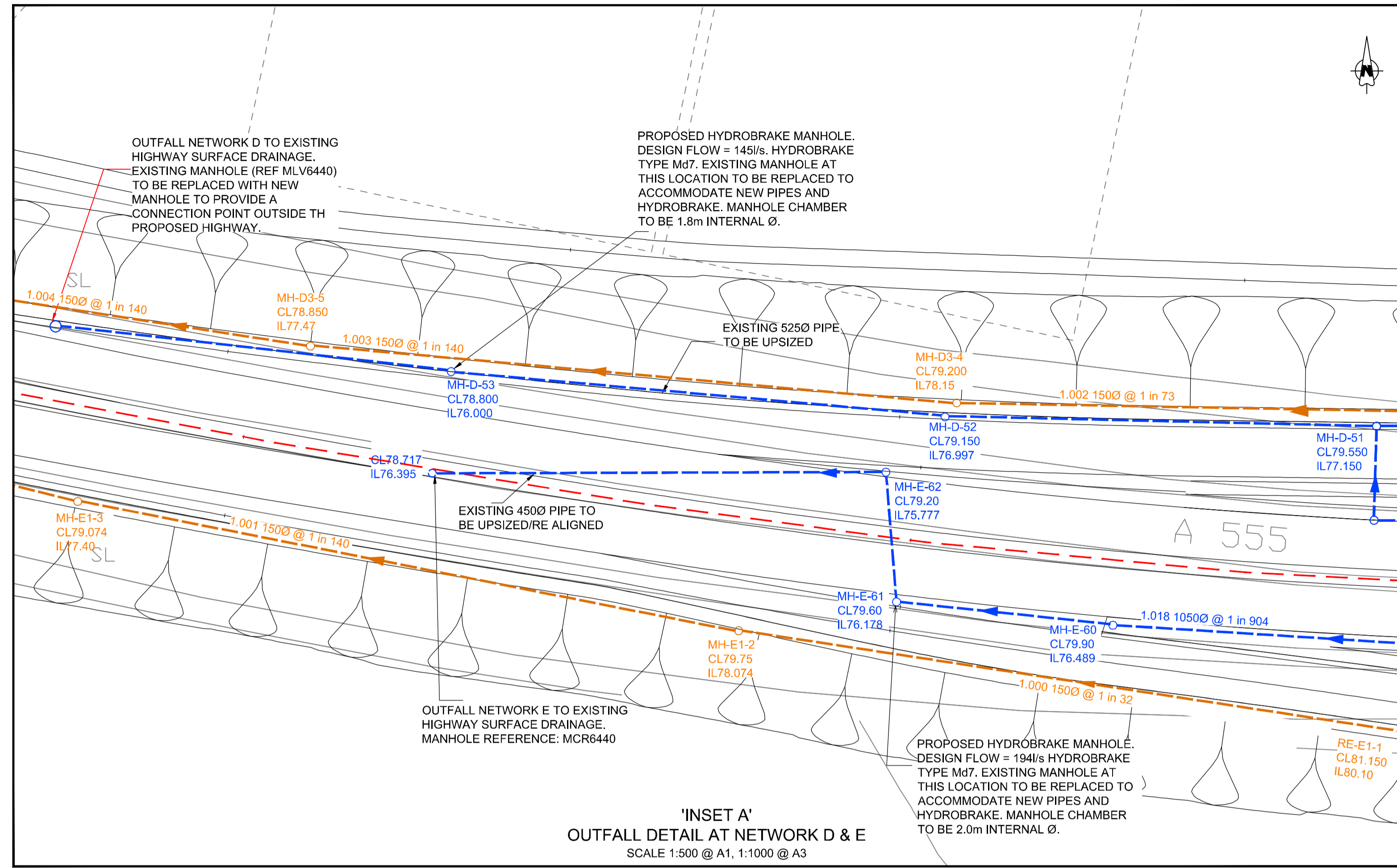

'INSET A'  
OUTFALL DETAIL AT NETWORK D & E  
SCALE 1:500 @ A1, 1:1000 @ A3

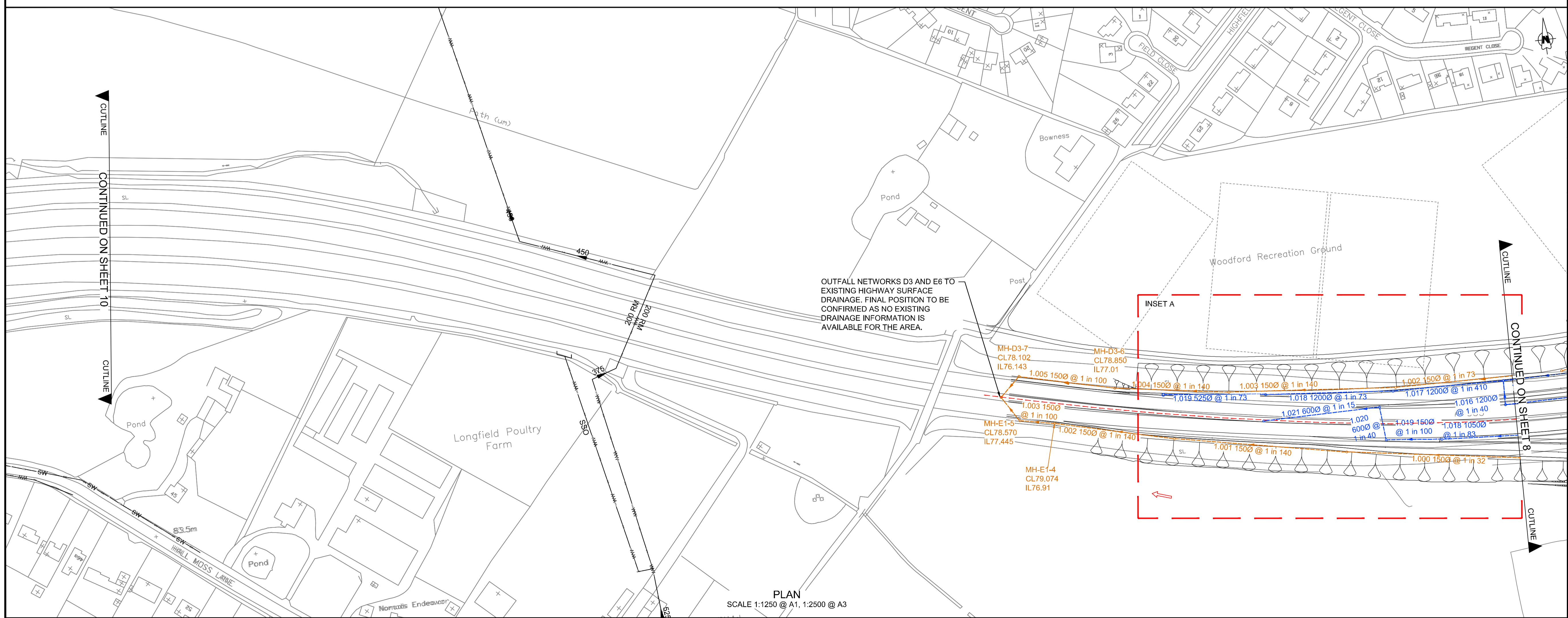

PLAN  
SCALE 1:1250 @ A1, 1:2500 @ A3

- NOTES:
- THIS DRAWING IS TO BE READ IN CONJUNCTION WITH ALL OTHER RELEVANT DRAWINGS AND THE AECOM DRAINAGE STRATEGY REPORT, DOCUMENT REFERENCE 60212470-HIG-002. ANY DISCREPANCIES, ERRORS OR OMISSIONS TO BE BROUGHT TO THE ATTENTION OF AECOM.
  - ALL DIMENSIONS TO BE CHECKED BEFORE COMMENCEMENT OF WORK ON SITE.
  - ALL DIMENSIONS IN METRES UNLESS OTHERWISE STATED.
  - PIPES Ø IN MILLIMETRES UNLESS OTHERWISE STATED.
  - ALL WORKS TO BE IN ACCORDANCE WITH THE SPECIFICATION FOR HIGHWAY WORKS (SHW).
  - ALL EARTHWORKS/GROUNDWATER DRAINAGE PIPES TO BE FILTER DRAINS WITH THE EXCEPTION OF PIPES RUNNING ACROSS HIGHWAY. THESE PIPES ARE TO BE UNPERFORATED CARRIER DRAINS.

- KEY:
- EXISTING DRAINAGE (COMBINED)
  - sw- EXISTING DRAINAGE (SURFACE)
  - EXISTING CULVERT
  - EXISTING WATERCOURSE
  - PROPOSED SYPHON
  - PROPOSED HIGHWAY DRAINAGE
  - PROPOSED EARTHWORKS / GROUNDWATER DRAINAGE
  - PROPOSED CULVERT
  - PROPOSED OUTFALL LOCATION
  - PROPOSED RISING MAIN
  - 1.005/A PROPOSED PIPE NETWORK NAME AND NUMBER
  - MH-A-1 PROPOSED MANHOLE/CATCHPIT NETWORK NAME AND NUMBER
  - RE-A-1 PROPOSED RODDING EYE NUMBER AND NETWORK NAME
  - PROPOSED POND/TANK
  - LIMIT OF DEVIATION
  - PROPOSED FENCELINE (TAKEN FROM LATEST HIGHWAY DESIGN LAYOUT)
  - DIRECTION OF PROPOSED HIGHWAY LONGFALL
  - EXISTING OIL PIPELINE
  - PROPOSED OIL PIPELINE
  - PROPOSED 300mm INTERNAL Ø SLIPFORM SLOT DRAIN (BY EXTRUDAKERB OR SIMILAR APPROVED). MAXIMUM LENGTH BETWEEN OUTFALLS APPROX 300m (TBC AT DETAIL DESIGN)

Rev	Date	Detail	Made	Chk'd	App'd
P06	26.04.13	UPDATED FOLLOWING REVISED TR1 DESIGN & SMBC COMMENTS	JR	PB	MCBH
P05	22.04.13	UPDATED FOLLOWING REVISED TR1 DESIGN & SMBC COMMENTS	JR	PB	MCBH
P04	18.03.13	AMENDED TO TR1 DESIGN	JR	PB	MCBH
P03	12.08.11	AMENDMENTS FOLLOWING COMMENTS FROM SMBC	VUM	MCBH	PJ
P02	13.07.11	AMENDMENTS FOLLOWING COMMENTS FROM SMBC	VUM	MCBH	PJ
P01	06.06.11	FIRST ISSUE FOR COMMENT	AJR	MCBH	PJ

Client:  
**STOCKPORT METROPOLITAN BOROUGH COUNCIL**

Project:  
**SEMMMS A6 RELIEF ROAD**

Title:  
**GENERAL ARRANGEMENT NETWORK D & E SHEET 9**

Design: PB CAD: AJR  
Chk'd: MCBH App'd: PJ  
Date: 06.06.11 Scale: AS SHOWN



AECOM  
Lynnfield House, Church Street,  
ALTRINCHAM, WA14 4DZ  
Tel: +44 (0) 161 927 8200  
Fax: +44 (0) 161 927 9499  
www.aecom.com

No. 60212470-HIG-0509  
Rev: P06  
A1

CAD File: F:\projects\Highways - SEMMMS A6 Relief Road\01 Autocad\01 Output\60212470-HIG-0509.dwg; Plotted on 4/26/2013 10:53 AM by Bainbridge, Paul